

FLOOR PLAN

Carmen & "Ski" Zielinski  
 954.4424.2360  
 Skimail@aol.com  
 www.carmenandski.com

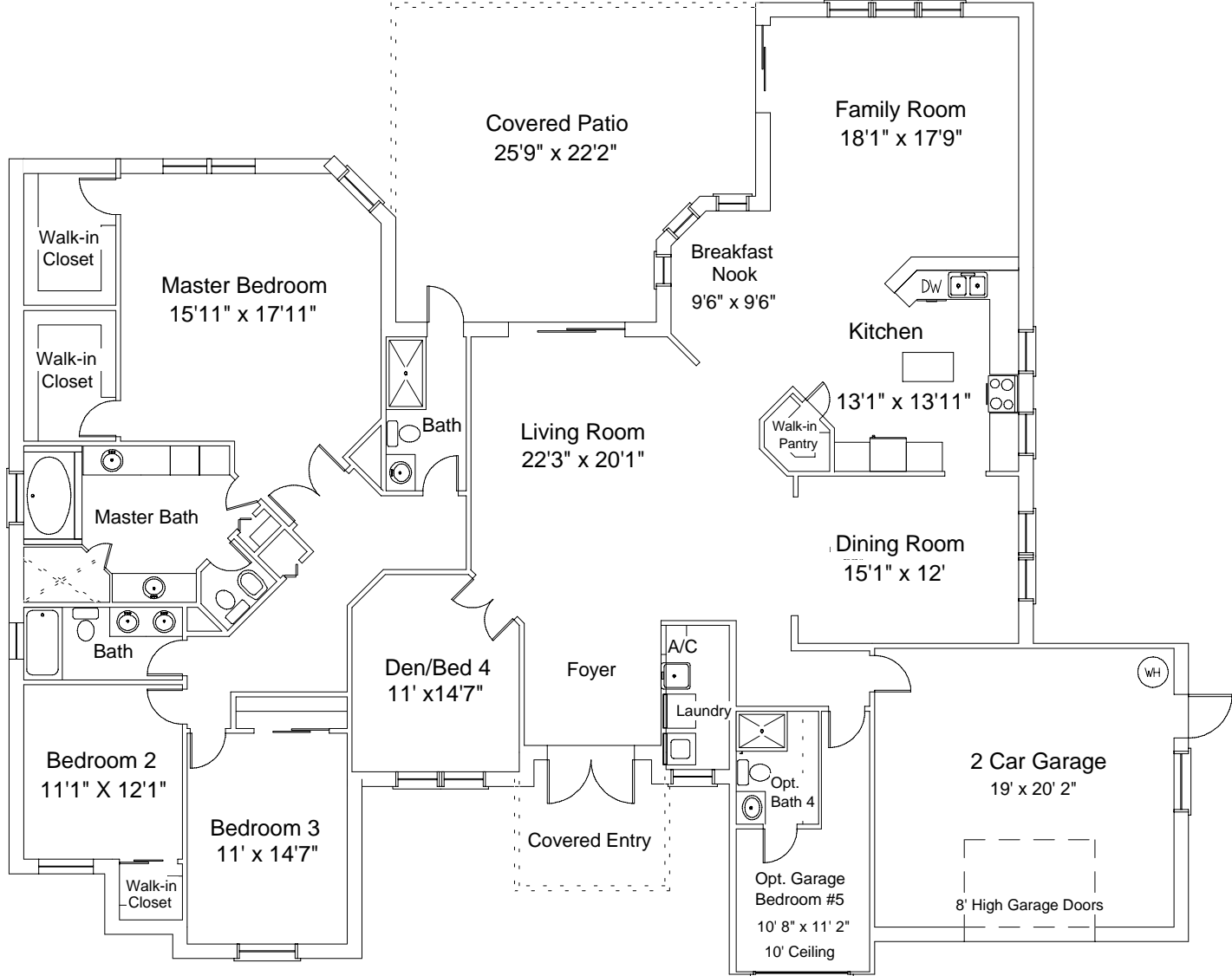

**Overview**

Community: Imagination Farms  
 Builder: Pasadena Homes  
 Model: The Dover  
 Bedrooms: 5  
 Baths: 4  
 Garage: 2-car  
 Living area Sq. Footage: 3302  
 Total Sq. Footage: 4,339  
 Roof: Concrete S-Tile  
 Driveway: Interlocking pavers

All information is believed to be accurate, but is not warranted.

Interested parties are invited to verify areas of concern.

If you would like to see all available homes with this floor-plan contact Carmen & "Ski" at 954.424.2360