

FLOOR PLAN

Carmen & "Ski" Zielinski
954-424-2360
Skimail@aol.com
www.carmenandski.com

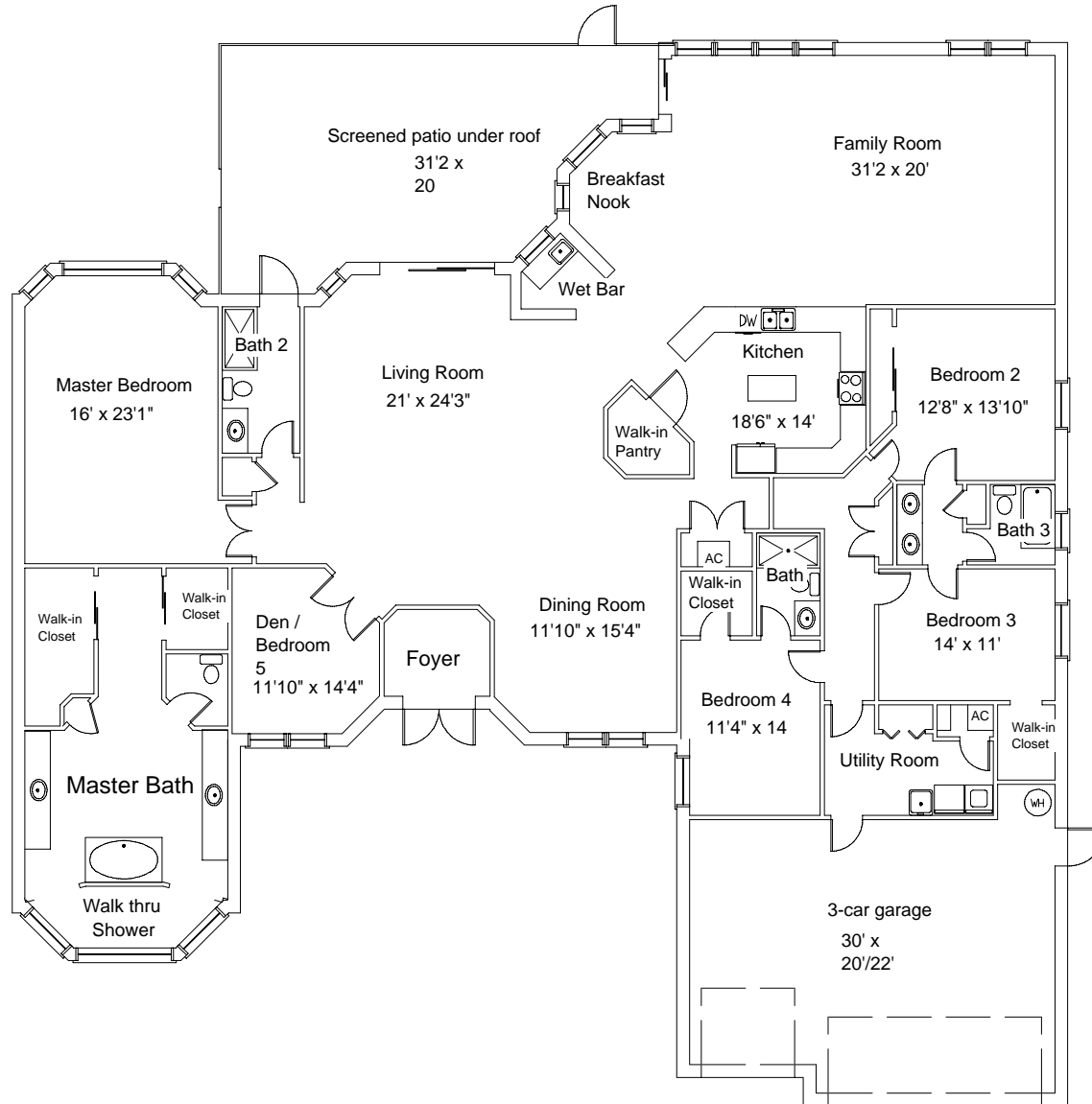

Overview

Model: The Hanver
Bedrooms: 5
Baths: 4
Garage: 3-car
Living area S.Footage: 4,150
Total Sq.Footage: 5,459
Roof: Concrete S-Tile

Builder: Pasadena Homes

The Hanover also came as an optional 6-bedroom and 5-bath home which increased living area to 4,376 sq.ft.

There was also an optional media room and 6th bath offered.

For floor-plan details on these models or to check market availability contact us.

All information is believed to be accurate, but is not warranted.

Interested parties are invited to verify areas of concern.

If you would like to see all available homes with this floor-plan contact Carmen & "Ski" at 954.424.2360